



A•mist¹⁰, A•mist²⁰ Oil Mist Filters

The Absolent type A•mist oil mist filter features one of the most effective systems in the world for cleaning oil mist. A•mist¹⁰ and A•mist²⁰ are available with different filter cassettes depending on the application and are designed for air flows up to 1000m³/h respectively 2000m³/h. The filter units are being placed adjacent to one or several machines. The A•mist^{20HP} version can even cope with longer duct lengths and thereby higher external pressure drops.

The highest possible collecting efficiency.

The filtered air becomes so clean that it usually can be returned to the premises. This means less loss of energy and a more balanced ventilation.

Extremely low maintenance.

Absolent filter units can usually run for at least one year without requiring a filter change. Moreover, A•mist filter cassettes can usually be washed.* This results in a low total cost of ownership.

A very reliable filter unit.

The fan, as the only moving component, is placed at the clean-side to minimize wear & tear.

Extremely low noise level for agreeable working conditions.

*Does not apply for the HEPA filter.

HEPA filter with 99,99% collecting efficiency

Centrifugal fan, positioned between the filters for low sound emission

Filter stage 2 (only A•mist^{20/HP})
Self-draining Absolent filter

Filter stage 1
Self-draining Absolent filter

Inlet duct

Return oil tank

Return oil pipe for drained liquid

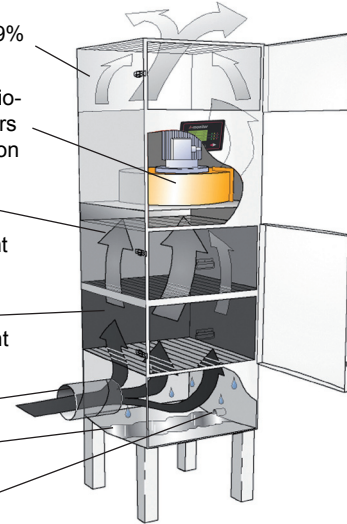

A•mist²⁰

Operation

The filtering process occurs in two (A•mist¹⁰) resp. three (A•mist^{20/HP}) stages. The process air passes first through the self-draining Absolent filter cassettes. Here, approximately 90% of the oil mist is arrested. The last stage consists of a HEPA filter, which has a guaranteed and consistent collecting efficiency of 99.99% arresting 0.3 µm dia. particles. The filter unit has an electronic pressure gauge, A•monitor, which shows the pressure drop over the different filter stages and indicates when a filter cassette is to be changed. Thanks to the continuous draining of the filter cassettes, the unit can be operated without interruptions. The return oil is collected at the bottom of the filter for recycling.

Range of Application

The Absolent A•mist is well suited for use in applications such as:

- Grinding (cutting fluid emulsion)
- Turning (cutting fluid emulsion)
- Milling (cutting fluid emulsion)
- Electrical discharge machining
- Machining, using straight oil and moderate loads

Functional design

The A•mist filter range has a highly robust tower design that occupies a minimum of floor space. Its hinged access doors make service still more convenient. The filter is supplied with a baked powder painted finish that adds colour to the shop floor.



A•mist²⁰

A•mist¹⁰

A•mist²⁰ / A•mist^{20HP}

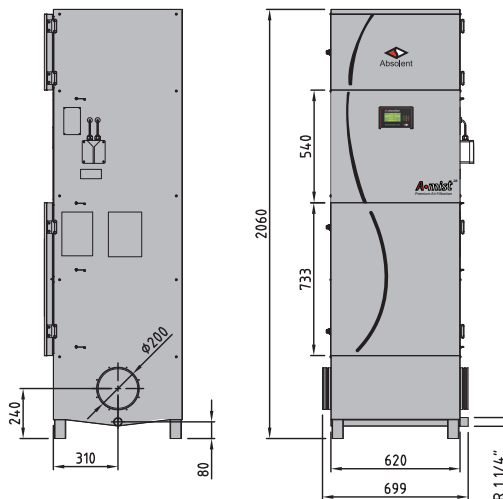
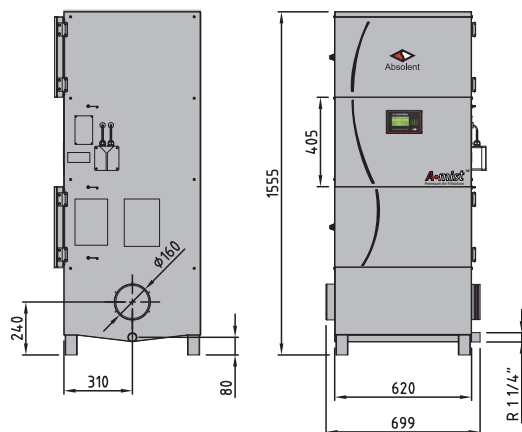

Technical Data

		A•mist ¹⁰	A•mist ²⁰ / A•mist ^{20HP}
Max permissible air volume	[m ³ /h]	1000	2000
Sound level, 1m in front of filter unit ¹⁾	[dB(A)]	64 ¹⁾	70/72 ¹⁾
Weight (dry filters)	[kg]	115	215/220
Available dim. ext. pressure drop	[Pa]	< 50	300/500
Filter area, filter 1 (Absolent filter)	[m ²]	12.8	14.3 ²⁾
Filterarea filter 2 (Absolentfilter)	[m ²]	-	12.8 ²⁾
Filter area, filter 3 (HEPA filter)	[m ²]	20.4	20,4
Fan Data			
Motor output	[kW]	0.55	2.2
Rated current (3-Phase, 400V)	[V]	380-420	380-420
Power supply	[A]	1.35	4.6
Speed	[rpm]	2800	2800

¹⁾ Sound absorption in premises=200m², Hemispherical sound propagation. For sound calculation concerning a specific room, contact us at Absolent or any of our dealers.

²⁾ The filter area varies for different applications.

Standard Equipment

- RAL 7035 fine structure
Other colours on request!
- Electronic manometer with the following features:
 - ✓ Pressure drop and operation hour meters
 - ✓ Optical indication of filter alarm (LED).
 - ✓ Digital output signal for remote supervision.

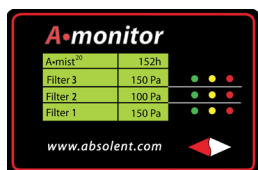

Accessories

- Motor starter for fan. Either a manual or protective motor contactor (for automatic or external starting)
- Outlet hood
- Carbon filter
- Duct connections for steel or plastic ductwork
- Extension legs, standard height 400 mm
- Water trap for various connections of the return oil pipe
- Pump unit for pumping the return oil from the filter.
- Sound insulation (-3 dB)
- Extra outlet silencers (-2 dB)
- Special colours

Sound level A•mist¹⁰, dB(A)¹⁾

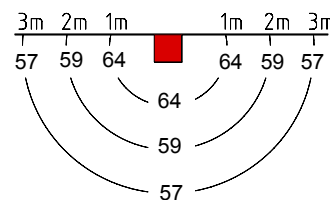

Sound level A•mist²⁰, dB(A)¹⁾

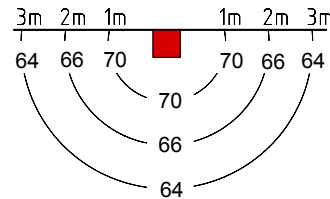

Sound level A•mist^{20HP}, dB(A)¹⁾

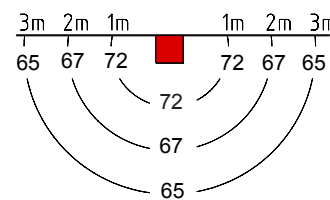

Unique filter cassettes

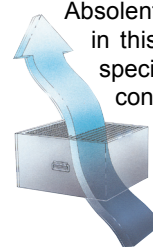

Absolent is one of few companies in this line of business that has specialized in the filtration of air containing wet particles.

This has given us the opportunity to develop a filter cassette that offers a long useful life with consistently high separation efficiency.

Absolent AB
Kartåsgatan 1
SE-531 40 Lidköping
Sweden
Tel: +46 (0)510-484000
Fax: +46 (0)510-484029
E-mail: info@absolent.se
Sweden • USA • China



Absolent
www.absolent.com

Dealer:



ENVIROTECH, s.r.o.
Priemyselný park VISOLAJE
018 61 Beluša
office@envirotech.sk
+421 917 432 369